

PAVEMENT STRUCTURE:

- | | |
|---|--|
| <p>LIGHT DUTY PAVEMENT
50mm ASPHALT OPSS 1150 HL3
150mm GRANULAR "A" OPSS 1010
375mm GRANULAR "B" OPSS 1010 TYPE II</p> | <p>HEAVY DUTY PAVEMENT
40mm ASPHALT OPSS 1150 HL3
80mm ASPHALT OPSS 1150 HL8
150mm GRANULAR "A" OPSS 1010
450mm GRANULAR "B" OPSS 1010 TYPE II</p> |
|---|--|

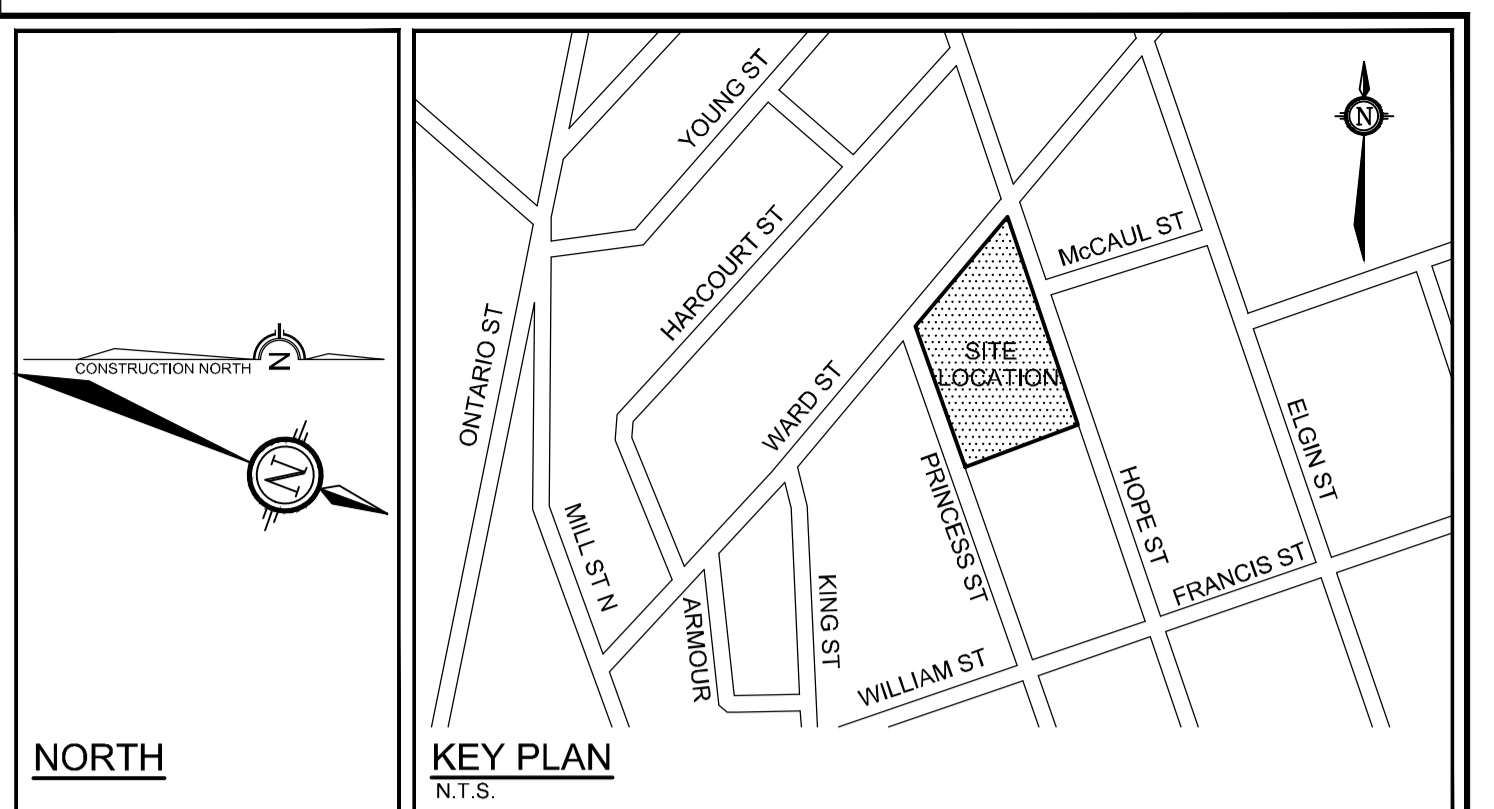
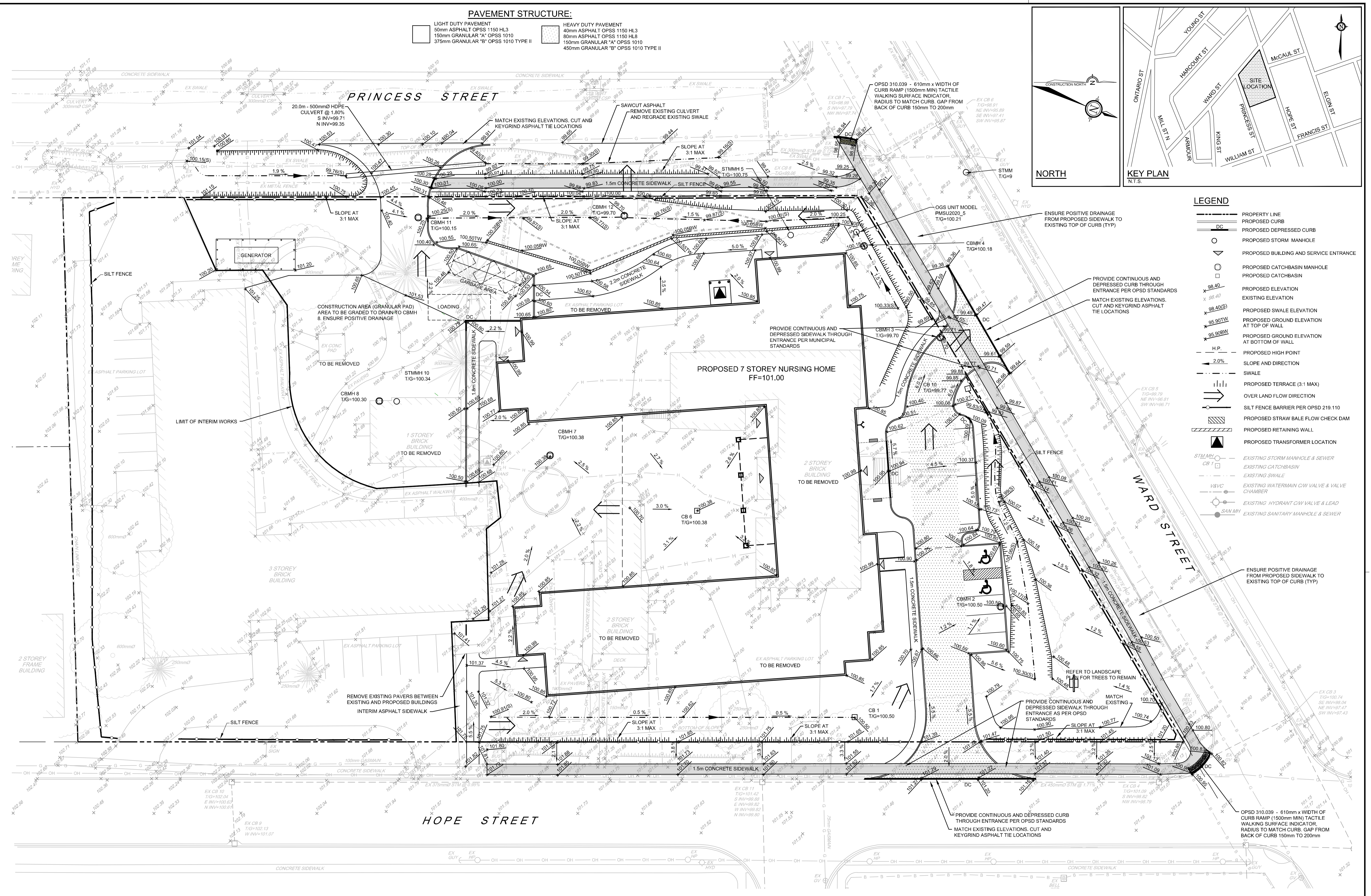

- LEGEND**
- PROPERTY LINE
 - PROPOSED CURB
 - PROPOSED DEPRESSED CURB
 - PROPOSED STORM MANHOLE
 - ▽ PROPOSED BUILDING AND SERVICE ENTRANCE
 - PROPOSED CATCHBASIN MANHOLE
 - PROPOSED CATCHBASIN
 - x 98.40 PROPOSED ELEVATION
 - x 98.40(S) EXISTING ELEVATION
 - x 95.90(TW) PROPOSED GROUND ELEVATION AT TOP OF WALL
 - x 95.90(BW) PROPOSED GROUND ELEVATION AT BOTTOM OF WALL
 - H.P. PROPOSED HIGH POINT
 - 2.0% SLOPE AND DIRECTION
 - SWALE
 - PROPOSED TERRACE (3:1 MAX)
 - OVER LAND FLOW DIRECTION
 - SILT FENCE BARRIER PER OPSD 219.110
 - PROPOSED STRAW BALE FLOW CHECK DAM
 - PROPOSED RETAINING WALL
 - ▲ PROPOSED TRANSFORMER LOCATION
 - STMM 10 ○ EXISTING STORM MANHOLE & SEWER
 - CB 1 ○ EXISTING CATCHBASIN
 - EXISTING SWALE
 - WVC ○ EXISTING WATERMAIN CW VALVE & VALVE CHAMBER
 - EXISTING HYDRANT CW VALVE & LEAD
 - EXISTING SANITARY MANHOLE & SEWER

NOTE:
THE POSITION OF ALL POLE LINES, CONDUITS, WATERMANS, SEWERS AND OTHER UNDERGROUND AND OVERGROUND UTILITIES AND STRUCTURES IS NOT NECESSARILY SHOWN ON THE CONTRACT DRAWINGS, AND WHERE SHOWN, THE ACCURACY OF THE POSITION OF SUCH UTILITIES AND STRUCTURES IS NOT GUARANTEED. BEFORE STARTING WORK, DETERMINE THE EXACT LOCATION OF ALL SUCH UTILITIES AND STRUCTURES AND ASSUME ALL LIABILITY FOR DAMAGE TO THEM.

No.	REVISION	DATE	BY
5	REVISED PER MUNICIPALITY COMMENTS	JAN 28/22	CJR
4	REVISED PER MUNICIPALITY COMMENTS	NOV 12/21	CJR
3	ISSUED FOR BUILDING PERMIT	AUG 31/21	CJR
2	ISSUED FOR SITE PLAN APPLICATION	JUNE 14/21	CJR
1	ISSUED FOR COORDINATION	JUNE 10/21	CJR

DESIGN	CHECKED	DRAWN	CHECKED	APPROVED
LSC	CJR	LSC	CJR	CJR

SCALE

1:250

FOR REVIEW ONLY

NOVATECH
Engineers, Planners & Landscape Architects
Suite 200, 240 Michael Cowpland Drive
Ottawa, Ontario, Canada K2M 1P6
Telephone: (613) 254-9643
Facsimile: (613) 254-5867
Website: www.novatech-eng.com

LOCATION
MUNICIPALITY OF PORT HOPE
65 WARD STREET / 20 HOPE STREET SOUTH

DRAWING NAME
SOUTHBRIDGE CARE HOMES
PORT HOPE NURSING HOME

GRADING PLAN
INTERIM CONDITIONS

PROJECT No. 120226
REV 5
DRAWING No. 120226-GR1

M:\2020\120226\CAD\Drawings\120226-GR.dwg, GR, NT, Jan 28, 2022, 2:07pm, dmarathia