

| LAND USE SCHEDULE  |                |             |
|--|----------------|-------------|
| LAND USE   | AREA           | SITE (%)    |
| LOTS 1-43<br>- 3036m <sup>2</sup> MIN. RURAL RESIDENTIAL                   | 15.95ha        | 43.6%       |
| BLOCK 100, 101<br>- SWM POND   | 0.72ha         | 2.0%        |
| BLOCK 102<br>- DRAINAGE EASEMENT   | 0.11ha         | 0.3%        |
| BLOCK 103<br>- WETLAND COMPENSATION/WATERCOURSE                            | 1.82ha         | 5.0%        |
| BLOCK 104<br>- 10-21 UNIT CONDOMINIUM/APARTMENT BUILDING                   | 0.67ha         | 1.8%        |
| BLOCK 105, 107<br>- REGULATED LANDS  | 12.90ha        | 35.3%       |
| BLOCK 106<br>- HYDRO EASEMENT  | 1.87ha         | 5.0%        |
| BLOCK 108<br>- FUTURE ROAD WIDENING  | 0.15ha         | 0.4%        |
| 20.0m MUNICIPAL ROAD ALLOWANCE<br>- STREET A, B, C, COUNTY ROAD 9 WIDENING | 2.40ha         | 6.6%        |
| <b>SITE TOTAL</b>  | <b>36.60ha</b> | <b>100%</b> |

**DRAFT PLAN OF SUBDIVISION**  
**GARDEN HILL ESTATES**  
**PLAN 39R-14329 - PART OF LOT 16, CONCESSION 8**  
**MUNICIPALITY OF PORT HOPE**  
**COUNTY OF NORTHUMBERLAND**

SCALE 1:1250

|             |                                   |          |
|-------------|-----------------------------------|----------|
| 2. 22/05/26 | REVISED PER MUNICIPALITY COMMENTS | C.O.     |
| 1. 18/04/22 | FIRST SUBMISSION                  | C.O.     |
| NO.         | DATE (D/M/Y)                      | REVISION |
|             |                                   | BY       |
|             |                                   | DATE     |

- ADDITIONAL INFORMATION REQUIRED - SECTION 51(17), PLANNING ACT**
- a) AS SHOWN ON THE DRAFT PLAN
  - b) AS SHOWN ON THE DRAFT PLAN
  - c) AS SHOWN ON THE DRAFT PLAN
  - d) SEE LAND USE SCHEDULE
  - e) AS SHOWN ON THE DRAFT PLAN
  - f) AS SHOWN ON THE DRAFT PLAN
  - f.1) NOT APPLICABLE
  - g) AS SHOWN ON THE DRAFT PLAN
  - h) WELL AND SEPTIC
  - i) CLAY SILT TO SILTY SAND
  - j) AS SHOWN ON THE DRAFT PLAN
  - k) NON APPLICABLE
  - l) AS SHOWN ON THE DRAFT PLAN
  - l.1) AS SHOWN ON THE DRAFT PLAN

**OWNER'S CERTIFICATE**  
 I AUTHORIZE MONUMENT GEOMATICS TO PREPARE AND SUBMIT THIS DRAFT PLAN FOR APPROVAL.

OWNER: MISTRAL LAND DEVELOPMENT INC.

**SURVEYOR'S CERTIFICATE**  
 I CERTIFY THAT THE BOUNDARIES OF THE LAND TO BE SUBDIVIDED AND CORRECTLY SHOWN.

ONTARIO LAND SURVEYOR  
 D.S. URSO.

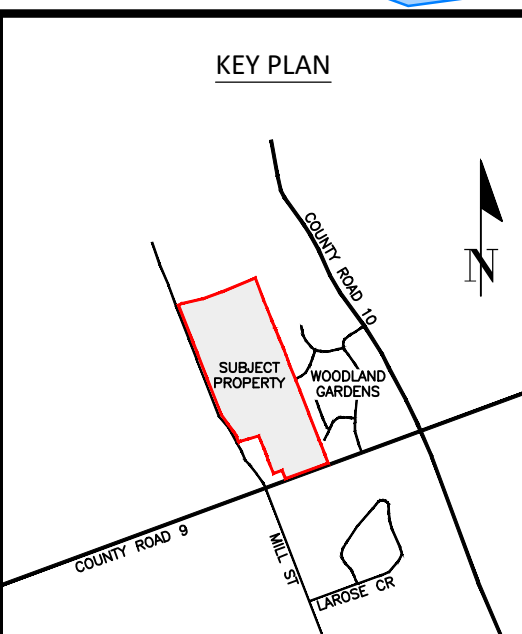

PROJECT No.: 21-0135  
 DRAWN: T.M.  
 CHECKED: C.O.  
 DATE: 22/05/26

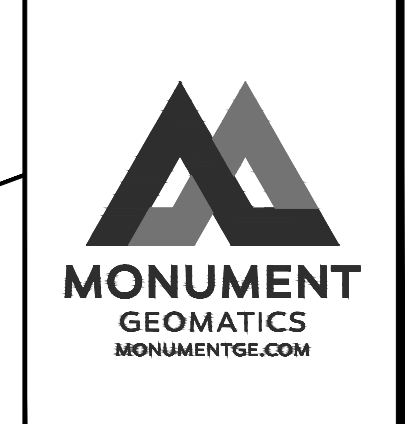

C:\Users\Yvon\OneDrive\Monument\Geomatics\2025\Garden Hill - General\1-Design\1-CSD\2022-05-28\_Garden Hill - Estimate\_2024\_PLAN.dwg  
 22/05/26 10:03:33 AM

DISCLAIMER/NOTICE TO THE RECIPIENT: THE INFORMATION GIVEN AND/OR DIGITAL FILES PROVIDED IS AN "AS-IS" BASIS WHEREBY THE RECIPIENT SHALL USE AT THEIR OWN RISK. MONUMENT GEOMATICS & ESTIMATING INC. MAKES NO GUARANTEES, REPRESENTATION, OR WARRANTIES REGARDING ANY INFORMATION, EITHER EXPRESSED OR IMPLIED, INCLUDING BUT NOT LIMITED TO THE COMPLETENESS, ACCURACY, OR USE FOR ANY PARTICULAR PURPOSE. USE OF ANY INFORMATION AND/OR DIGITAL FILES PROVIDED INDICATES THAT THE RECIPIENT AGREES TO THE AFOREMENTIONED TERMS. UNLESS OTHERWISE AGREED TO IN WRITING BY BOTH PARTIES, THE AFOREMENTIONED TERMS SHALL GOVERN ANY AND ALL FUTURE TRANSFERS OF ADDITIONAL DIGITAL INFORMATION. GENERAL NOTES: ALL INFORMATION TO BE VERIFIED ON SITE PRIOR TO COMMENCING ANY WORK-ALL UTILITY LOCATIONS SHOWN ON THE DRAWINGS ARE APPROXIMATE. ALL DIMENSIONS SHOWN ARE IN METERS OR MILLIMETERS, UNLESS OTHERWISE NOTED.